

# SMART3H

3-part wbc differential analyzer

- 21 parameters
- One-click operation
- Syringe Maintenance-Free
- Super user-friendly software
- Made from world's best key component



**Simplicity** when it  
matters most

**Heidelberg Medical Industries Co., Ltd**

Sector (4), Plot No. (3+14), Building (6), Al-Muwaqqar Industrial City, Amman, Hashemite Kingdom of Jordan • Tel: 700 5 200 6 962 • Fax: 7455 200 6 962  
Email: [info@heidelmedical.com](mailto:info@heidelmedical.com) • Website: <http://www.heidelmedical.com>

**CONTACT US**



### Micro sample volume

9 $\mu$ L whole blood request  
Only Ease pain during blood collection  
Benefit for pediatric elder and server bleeding patients

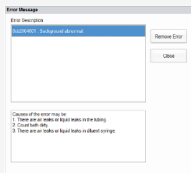

### Micro sample volume

9 $\mu$ L whole blood request  
Only Ease pain during blood collection  
Benefit for pediatric elder and server bleeding patients



### Convenient operation

Inches touch screen 10.4  
USB ports for multiply external devices 4  
Build an easy operation experience

### probe anti-block design

- Bottom is close, aspiration hole is on left side
- One button to automatically sample count

### Compact design

Small footprint, Build-in lyse position  
Save space for small labs

### built in printer

57 mm thermal printer with various formats  
for easy operation, and compatible with  
external printers.

## Product Specifications

**Throughput:** 60 samples/hour.

**Detection channel:** Dual-channel for counting.

**Leading technology:** Pulse baseline tracking technology, waveform discrimination technology, and intelligent floating threshold technology.

**Detection principle:** Impedance method (WBC/RBC/PLT) and cyanide free colorimetric method (HGB).

**Detection items:** The detection items include 21 parameters: report parameters (WBC, Lym#, Mid#, Gran#, Lym%, Mid%, Gran%, RBC, HGB, HCT, MCV, MCH, MCHC, RDW-CV, RDW-SD, PLT, MPV, PDW, PCT, P-LCR, and P-LCC), 3 histograms, alarm for abnormal erythrocytes, leukocyte, and platelet.

**Sample volume:** Minimum volume 9  $\mu$ L.

**Counting modes:** Venous whole blood, capillary whole blood, and pre-diluted blood.

**Reference value setting:** Pediatrics, male adult, female adult, general and user-defined.

**Alarm system:** Reliable alarm system with customized function.

**Quality control system:** L-J and X-B.

**Printout:** Built-in thermal recorder, supports various types of printer. Large numbers of built-in print templates are available.

**Storage:** 50,000 sample results, including parameter, histogram, and patient information.

**Input/output:** 4 USB ports and Bi-directional LIS connection.

**Operating environment:** Temperature 10°C to 30°C; relative humidity  $\leq$  85%.

**Power requirement:** 100-240V; 50/60 Hz.

**Dimensions:** 410mm $\times$ 353mm $\times$ 471mm.

**Weight:**  $\leq$ 25KG.